



SUPERIOR  
COATING

LOWEST PRICE  
GUARANTEE



## The veranda with lots of expansion options



Gumax® Excellence **verandas**,  
**sliding doors**, **sun shading** and **lighting**

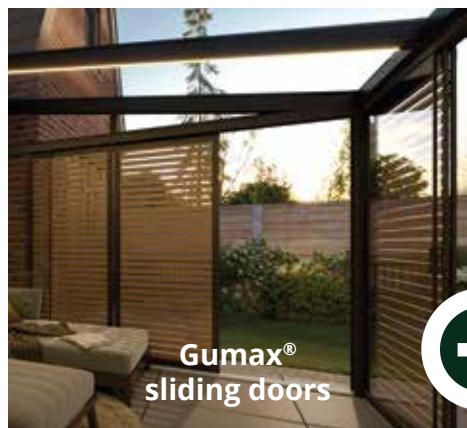

Gumax®  
sliding doors

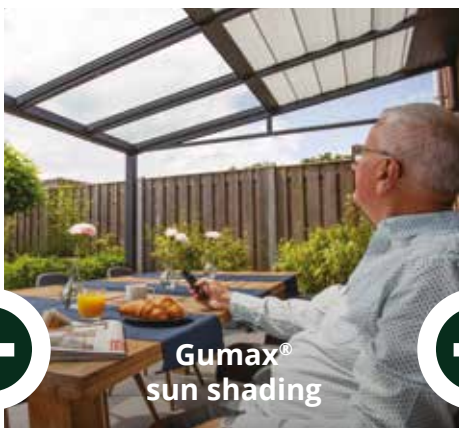

Gumax®  
sun shading



Gumax®  
lighting

[tuinmaximaal.co.uk](https://tuinmaximaal.co.uk)



Modern anthracite veranda measuring 11.06 x 4 metres with an IQ Relax polycarbonate roof.

"The package was fully complete. We didn't need to buy a thing - not even a single screw. Excellent!"

- Pete -

Veranda from

**987,-**

Lowest price guarantee

# Gumax® Excellence verandas and carports

## Living and garden pleasure in one

We want to allow more people to enjoy their gardens to the fullest throughout the year. That is why Tuinmaximaal offers a wide range of Gumax® Excellence verandas and carports of unparalleled quality.

Various extension options allow you to put together your veranda or carport entirely as you wish and step by step.

Classic white veranda measuring 6.06 x 3 metres with an opal polycarbonate roof including struts.

**SUPERIOR COATING**

**LOWEST PRICE GUARANTEE**

**Step 1**

**Select your colour and style**

For your Gumax® Excellence veranda, you can choose from:

- + Classic or modern style;
- + Colour matt anthracite (RAL 7016), matt white (RAL 9016) and matt black (RAL 9005).

**Gumax® Excellence - Superior coating**

People often forget to inquire about the coating used on aluminium products. Since there is a lot of variety in the quality of coatings used on the veranda market, we want to stress the importance of their quality. A few years after installation, you will definitely see the difference between the coatings. If you opt for Gumax® Excellence, you get a coating that retains its colour and gloss excellently. A matt coating from a global leader in powder coatings that gives you peace of mind.

The AkzoNobel Interpon coating applied to Gumax® products is designed for outdoor environments and offers excellent and long-lasting resistance to UV light and various weather conditions.

Gumax® Excellence - Superior coating offers:

- + Excellent gloss and colour retention;
- + From AkzoNobel - Interpon, global leader in powder coatings;
- + Low maintenance;
- + Designed to meet QUALICOAT performance requirements.

**Modern**

**Classic<sup>1</sup>**

**Anthracite (RAL 7016)**

**White (RAL 9016)**

**Black (RAL 9005)**

<sup>1</sup> The classic style is only available in anthracite and white. Sample colours below may differ from reality.





**Step 2 Select your roof type**  
For your Gumax® Excellence veranda, you can choose from the 5 roof types below. Alle roof panels have a unique panel width of 980 mm. All polycarbonate roof panels have a honeycomb structure. Glass roofs are made of tempered and layered 4-4-2 glass.



Roof panels	Clear glass	Opal glass	Clear polycarbonate	Opal polycarbonate	IQ Relax polycarbonate
Light permeability	88%	63%	70%	55%	47%
Energy permeability	85%	52%	62%	54%	44%
Noise reduction	36 dB	36 dB	21 dB	21 dB	21 dB
Thickness	8,76 mm	8,76 mm	16 mm	16 mm	16 mm
Dirt visible	Yes	Barely	Somewhat	Barely	Barely
Condensation visible	-	-	Yes	Barely	Barely

Above roof panels have their own properties when it comes to energy and light transmission.

Want to effectively counteract heat radiation? **Gumax® sun shading reflects 89% of direct heat radiation on all roof panels.**

Please note: the above percentages are indicative.

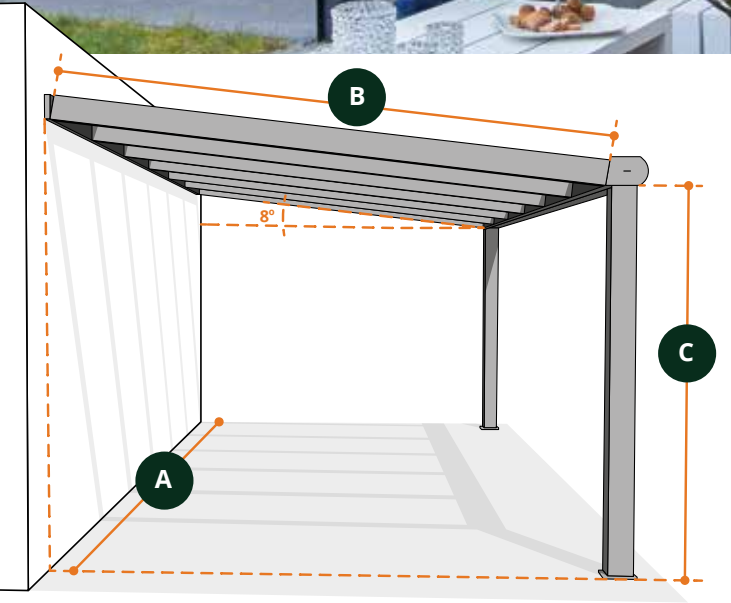
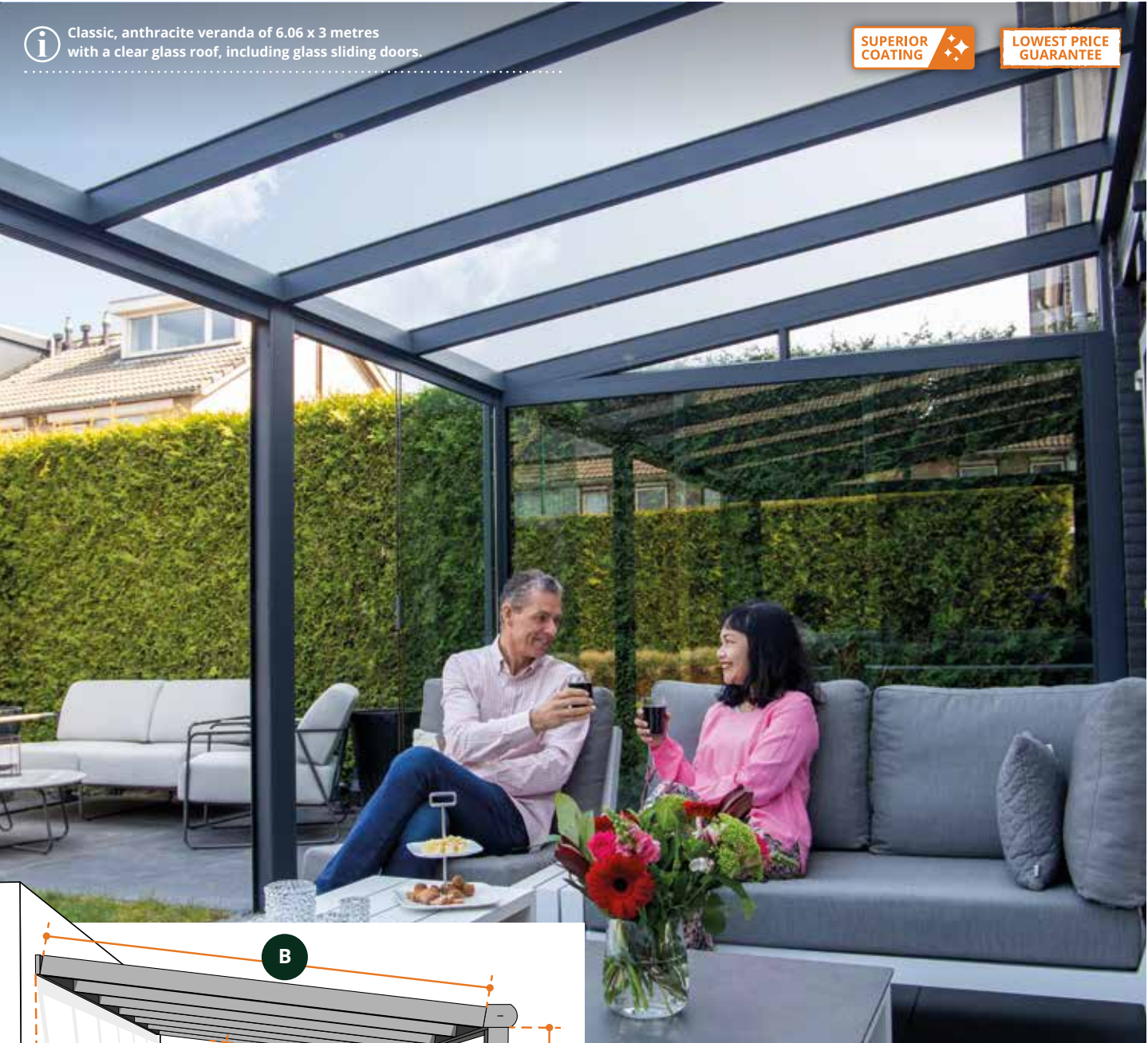

**Step 3 Determine the dimensions**  
**A: width**  
Gumax® Excellence verandas are supplied as standard from 3.06 metres wide and go up per metre: 3.06 m, 4.06 m, 5.06 m, 6.06 m etc. The width can easily be shortened to size.

**B: depth**  
Gumax® Excellence verandas are supplied as standard in depths of 2.5 m, 3.0 m, 3.5 m or 4.0 m. For a veranda with a polycarbonate roof, all depths can be cut to size. This makes it possible to achieve any depth up to 4.0 metres. A glass roof is only available in standard sizes. **Please note:** no sun shading can be fitted when shortening the depth. In this case, glass sliding doors cannot be mounted on the sides of your veranda either, as the standard Gumax® glass wedge will no longer fit.

**C: height**  
Tuinmaximaal recommends thinking about the height in advance and recommends a height to the bottom of the gutter of 2.10 m, 2.15 m, 2.20 m, 2.25 m, 2.30 m or 2.35 m. With these dimensions, the glass sliding doors under the veranda always fit exactly and spot foundations can still be dug in easily.

Calculate the clearance height and the height at which the wall profile should be mounted at: [www.tuinmaximaal.co.uk/measuring-tool](http://www.tuinmaximaal.co.uk/measuring-tool)

**Gumax®: quality & CE marking**  
You should be able to enjoy yourself safely under your veranda. Where other veranda brands use 6060-T6 aluminium, Gumax® Excellence verandas are made from the 25% stronger 6063-T6 aluminium. Moreover, aluminium itself offers many advantages. The material:  
+ Is very low maintenance;  
+ Has a long lifespan;  
+ Is not affected by moisture or UV radiation.  
  
Gumax® Excellence verandas are also:  
+ Able to withstand a load of 80 kg per m² thanks to the galvanised steel strip in the gutter;  
+ Equipped with CE marking, thus complying with the required European construction standards;  
+ Resistant to winds up to hurricane force and severe earthquakes.

Always ask for the CE marking when purchasing a veranda.





Gumax® Excellence veranda with polycarbonate roof				
	2.5 m	3 m	3.5 m	4 m
3.06 m	£ 987,-	£ 1.160,-	£ 1.471,-	£ 1.729,-
4.06 m	£ 1.427,-	£ 1.586,-	£ 1.729,-	£ 1.873,-
5.06 m	£ 1.729,-	£ 1.916,-	£ 2.076,-	£ 2.365,-
6.06 m	£ 1.959,-	£ 2.147,-	£ 2.335,-	£ 2.667,-
7.06 m	£ 2.161,-	£ 2.379,-	£ 2.594,-	£ 3.055,-
8.06 m	£ 2.811,-	£ 2.941,-	£ 2.985,-	£ 3.416,-
9.06 m	£ 2.868,-	£ 3.128,-	£ 3.388,-	£ 3.820,-
10.06 m	£ 3.244,-	£ 3.604,-	£ 3.950,-	£ 4.311,-
11.06 m	£ 3.589,-	£ 3.950,-	£ 4.324,-	£ 4.743,-
12.06 m	£ 3.935,-	£ 4.311,-	£ 4.541,-	£ 5.148,-



Gumax® Excellence veranda with clear glass roof				
	2.5 m	3 m	3.5 m	4 m
3.06 m	£ 1.517,-	£ 1.897,-	£ 2.217,-	£ 2.782,-
4.06 m	£ 2.018,-	£ 2.292,-	£ 2.724,-	£ 3.257,-
5.06 m	£ 2.448,-	£ 2.797,-	£ 3.314,-	£ 4.094,-
6.06 m	£ 2.824,-	£ 3.198,-	£ 3.820,-	£ 4.729,-
7.06 m	£ 3.171,-	£ 3.604,-	£ 4.324,-	£ 5.463,-
8.06 m	£ 3.964,-	£ 4.324,-	£ 4.959,-	£ 6.156,-
9.06 m	£ 4.165,-	£ 4.699,-	£ 5.597,-	£ 6.898,-
10.06 m	£ 4.685,-	£ 5.334,-	£ 6.415,-	£ 7.743,-
11.06 m	£ 5.175,-	£ 5.766,-	£ 7.036,-	£ 8.504,-
12.06 m	£ 5.497,-	£ 6.257,-	£ 7.496,-	£ 9.254,-



Gumax® Excellence veranda with opal glass roof				
	2.5 m	3 m	3.5 m	4 m
3.06 m	£ 1.925,-	£ 2.283,-	£ 2.664,-	£ 3.337,-
4.06 m	£ 2.420,-	£ 2.750,-	£ 3.270,-	£ 3.908,-
5.06 m	£ 2.940,-	£ 3.357,-	£ 3.978,-	£ 4.913,-
6.06 m	£ 3.390,-	£ 3.839,-	£ 4.584,-	£ 5.673,-
7.06 m	£ 3.797,-	£ 4.324,-	£ 5.188,-	£ 6.556,-
8.06 m	£ 4.756,-	£ 5.188,-	£ 5.952,-	£ 7.388,-
9.06 m	£ 4.999,-	£ 5.639,-	£ 6.729,-	£ 8.288,-
10.06 m	£ 5.621,-	£ 6.399,-	£ 7.699,-	£ 9.289,-
11.06 m	£ 6.209,-	£ 6.920,-	£ 8.442,-	£ 10.204,-
12.06 m	£ 6.608,-	£ 7.508,-	£ 8.994,-	£ 11.097,-

All prices include VAT and apply to both styles and all colours.  
With a polycarbonate roof, you have a choice of 3 types of polycarbonate.  
Tuinmaximaal uses standard widths and depths.

Required number of support structures	
Colour indication	Support structures
	2 pieces
	3 pieces
	4 pieces

The veranda  
with lots of expansion options

Complete your veranda with:

Gumax®  
sliding doors

P.8

Gumax®  
sun shading

P.18

Gumax®  
lighting

P.22

**Step 4 Foundation**  
A Gumax® Excellence veranda must be mounted on a substrate that can support a weight of up to 750 kg per support structure. Tuinmaximaal recommends using Gumax® spot foundations for this purpose. With spot foundations, you distribute the force that the veranda exerts on the substrate. If you have a veranda with a concrete foundation, the veranda can be installed without additional spot foundations.

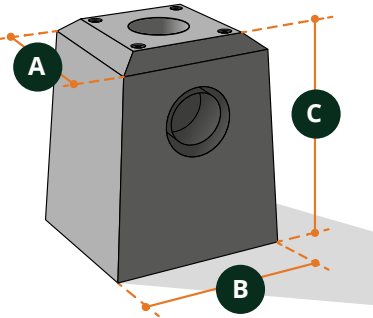

**A:** top 210 mm, **B:** bottom 250 mm and **C:** height 275 mm.



Gumax® spot foundations	
+ Available with and without rainwater drainage (RWD).	
	Price per set
2 Support structures	£ 178,-
3 Support structures	£ 249,-
4 Support structures	£ 317,-

**Step 5 Separate parts and accessories**  
Complete your Gumax® Excellence veranda with matching accessories. All powder-coated accessories are available in matt anthracite (RAL 7016), matt white (RAL 9016) and matt black (RAL 9005).



Gumax® wedge on fence				
+ To close off sidewalls on top of or next to a wall or fence; + Available in clear, opal and IQ Relax polycarbonate; + Plate width of 980 mm, also the maximum height; + Can be shortened as required.				
	2.5 m	3 m	3.5 m	4 m
Price per piece	£ 189,-	£ 223,-	£ 259,-	£ 295,-



Gumax® polycarbonate sidewall				
+ To close off the entire side of the Gumax® Excellence veranda; + Available in clear, opal and IQ Relax polycarbonate; + Available for all depths up to 4 metres.				
	2.5 m	3 m	3.5 m	4 m
Price per piece	£ 650,-	£ 780,-	£ 911,-	£ 1.041,-



Gumax® strut	
+ For a unique and rural style; + Both one and two struts per support structure possible; + Glass sliding doors not possible in combination with struts.	
	Price
Strut	£ 58,-

Miscellaneous products	
	Price
Paint stick	£ 28,-
Spray can	£ 56,-



**i** Modern anthracite veranda measuring 4.06 x 3.5 metres with a clear glass roof including glass sliding doors.

"With the assembly instructions provided, it was easy to assemble the glass sliding doors."

- Christian -

Glass sliding doors from

**453,-**

Lowest price guarantee

## Gumax® glass sliding doors

### Keep the wind and cold out

Enjoy your garden to the fullest throughout all seasons with Gumax® glass sliding doors under your veranda. Thanks to the clear glass, little daylight is lost and you can sit comfortably under your veranda even on colder days.

Add various accessories to your Gumax® glass sliding door according to your own taste. Gumax® glass sliding doors are also suitable for other brands of verandas and extensions.

**i** Modern white veranda measuring 5.06 (shortened) x 3 metres with an opal polycarbonate roof including glass sliding door.

**SUPERIOR  
COATING**

**LOWEST PRICE  
GUARANTEE**

#### Total height of glass sliding door system

Gumax® glass sliding doors are available in heights ranging from 2000 mm to 2700 mm. A clearance of 20 mm upwards and 20 mm downwards is possible. The height of the complete system is calculated including the bottom rail, overhead rail and glass profile. So this is the only dimension you have to take into account. Is your veranda designed with a slope? In this case, both the lowest and the highest size must fall within the dimensions in the adjacent table.

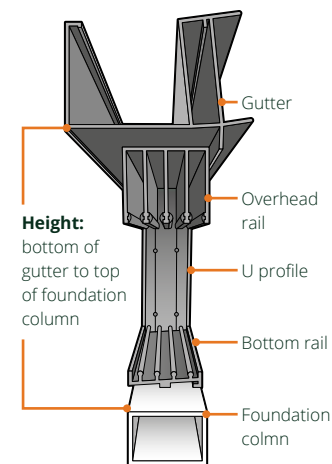

Height of rail systems from top of foundation to bottom of gutter/beam +/- 20 mm clearance.

2000 mm	2200 mm	2400 mm
2050 mm	2250 mm	2500 mm
2100 mm	2300 mm	2600 mm
2150 mm	2350 mm	2700 mm





**i** Modern anthracite veranda measuring 5.06 x 3 metres with an opal polycarbonate roof including glass sliding doors.



**Width dimensions glass sliding doors**  
Gumax® glass sliding doors are available from a 1-rail to a 6-rail system. If you use the full length of a rail, there is no overlap between the glass panels. The width of the glass sliding door is measured from support structure to support structure.

Product detail				
Glass profile (for every system):				
Length: 980 mm x Width: 16.60 mm x Height: 73.40 mm.				
	Length	Width	Height	
1-rail	overhead rail	1960 mm	23,18 mm	75,50 mm
	bottom rail	1960 mm	35,00 mm	17,77 mm
2-rail	overhead rail	1960 mm	43,35 mm	75,50 mm
	bottom rail	1960 mm	48,95 mm	17,77 mm
3-rail	overhead rail	2940 mm	64,70 mm	75,50 mm
	bottom rail	2940 mm	70,30 mm	17,77 mm
4-rail	overhead rail	3920 mm	86,05 mm	75,50 mm
	bottom rail	3920 mm	91,65 mm	17,77 mm
5-rail	overhead rail	4900 mm	107,40 mm	75,50 mm
	bottom rail	4900 mm	113,00 mm	17,77 mm
6-rail	overhead rail	5880 mm	128,76 mm	75,50 mm
	bottom rail	5880 mm	134,35 mm	17,77 mm

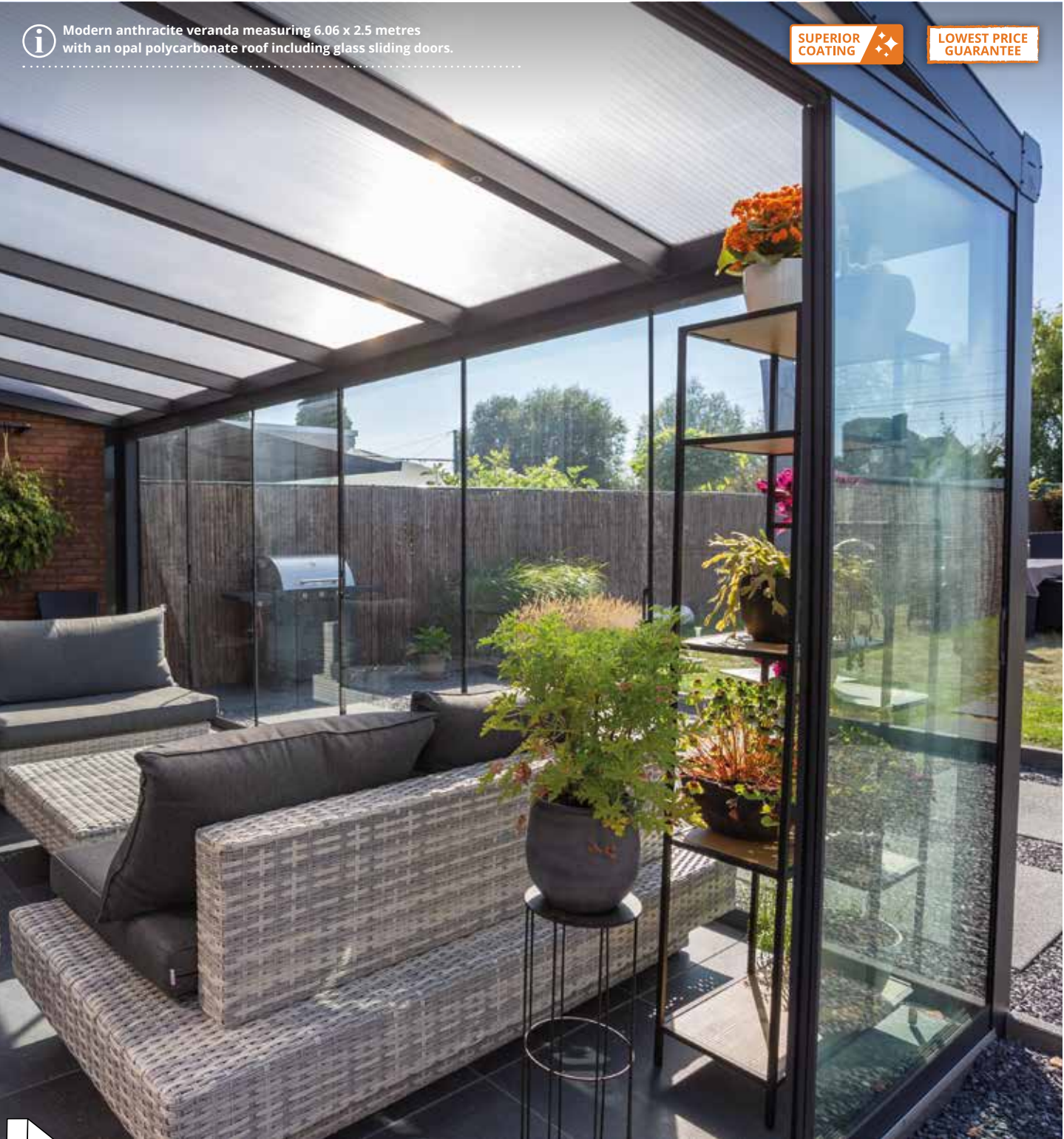

**i** Modern anthracite veranda measuring 6.06 x 2.5 metres with an opal polycarbonate roof including glass sliding doors.

SUPERIOR COATING

LOWEST PRICE GUARANTEE

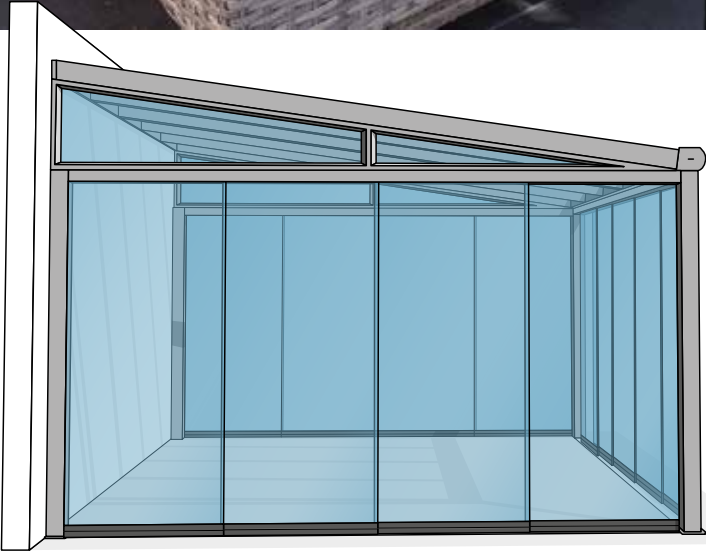

**Measuring instructions glass sliding doors**  
When you use the full length of a rail, there is no overlap between the glass panels, as the glass panels are 980 mm wide. The rail systems are easy to shorten. You calculate the overlap per panel by dividing the length you shorten by the number of panels minus one.

**Example:** you want to shorten a 4-rail system by 210 mm. A 4-rail system contains 4 glass panels. Remove one glass panel from this for the calculation. Indeed, there are 3 places where overlap is possible. The overlap per glass panel is 210 : 3 = 70 mm.

If the opening you want to close is larger than 5880 mm, you have the options below:

1. Reduce the opening to a maximum of 5880 mm by closing part of the opening.
2. Divide the opening in two with an extra support structure, so you can place two separate rail systems.



Classic anthracite veranda measuring 6.06 x 3 metres with a clear glass roof including glass sliding doors.

SUPERIOR COATING

LOWEST PRICE GUARANTEE

Suitable for most verandas and garden houses

Gumax® glass sliding door	
Prices below apply to all colours.	
✦ Up to a width of 5880 mm; ✦ Height sizes from 2000 mm to 2700 mm; ✦ 10 mm thick safety glass; ✦ Integrated water drainage.	
	Price
1-rail (length: 1960 mm)	£ 453,-
2-rail (length: 1960 mm)	£ 604,-
3-rail (length: 2940 mm)	£ 908,-
4-rail (length: 3920 mm)	£ 1.209,-
5-rail (length: 4900 mm)	£ 1.512,-
6-rail (length: 5880 mm)	£ 1.812,-

**Foundation**  
Installing Gumax® glass sliding doors requires a strong foundation that is level and can support up to 390 kg per linear metre. Tuinmaximaal recommends installing Gumax® aluminium foundation beams for this purpose to prevent subsidence.



Gumax® foundation columns	
	Price per piece
1-rail (length: 1960 mm)	£ 139,-
2-rail (length: 1960 mm)	£ 153,-
3-rail (length: 2940 mm)	£ 181,-
4-rail (length: 3920 mm)	£ 207,-
5-rail (length: 4900 mm)	£ 236,-
6-rail (length: 5880 mm)	£ 276,-



**Separate parts and accessories**  
To install Gumax® glass sliding doors on the side of the veranda, a Gumax® glass wedge is required. You can further complete your Gumax® glass sliding door with various Gumax® accessories, such as decorative and weather strips, door handles, U profiles and Gumax® Shading Panels. All accessories are available in matt anthracite (RAL 7016), matt white (RAL 9016) and matt black (RAL 9005).



Gumax® glass wedge				
✦ Has a standard angle of 8 degrees.				
	2.5 m	3 m	3.5 m	4 m
Price per piece	£ 387,-	£ 490,-	£ 603,-	£ 741,-



Glass sliding door accessories	
	Price per piece
Door handle Curve	£ 31,-
Door handle Square	£ 31,-
Door handle Square Large	£ 44,-
Decorative strip (without hair)	£ 18,-
Weather strip (with hair)	£ 31,-
U profile (2x) Set 1-rail	£ 131,-
U profile (2x) Set 2-rail	£ 144,-
U profile (2x) Set 3-rail	£ 169,-
U profile (2x) Set 4-rail	£ 196,-
U profile (2x) Set 5-rail	£ 222,-
U profile (2x) Set 6-rail	£ 248,-

**Simple construction kit**  
You can easily assemble the Gumax® glass sliding door yourself with the complete construction kit and step-by-step assembly instructions.





Modern black veranda measuring 6.06 x 4 metres with a clear glass roof including Shading Panel and Lighting System.

"The panels provide a very attractive look to my veranda."

PATENT  
PENDING

SUPERIOR  
COATING

LOWEST PRICE  
GUARANTEE

Shading Panel from

**469,-**

Lowest price guarantee

**NEW!**

## Gumax® Shading Panel

### The outdoor shutters for your veranda

Easily create more shade, shelter and privacy under your veranda. With a timeless design and wide range of colours, Gumax® Shading Panels fit under any veranda, even a wooden one. Configure your Gumax® Shading Panels to your own taste, combine them with Gumax® glass sliding doors and slide them into the glass sliding doors' convenient rail system. The shelter you want at any time.

- + Shade and shelter where you want it;
- + Always have the privacy you want;
- + Slide easily;
- + In combination with glass sliding doors;
- + Set up optimal air flows;
- + Choice of slats in 7 colours;
- + Fits under almost any veranda;
- + Water resistant thanks to Rhombus design;
- + Superior coating.



#### Shade or shelter

Shift the panels and decide where you want more shade, shelter or privacy.



#### Easy installation

Install the panels easily and quickly with the convenient DIY sliding system.



#### Creating optimal airflow

Create an area under your veranda that feels both open and sheltered.



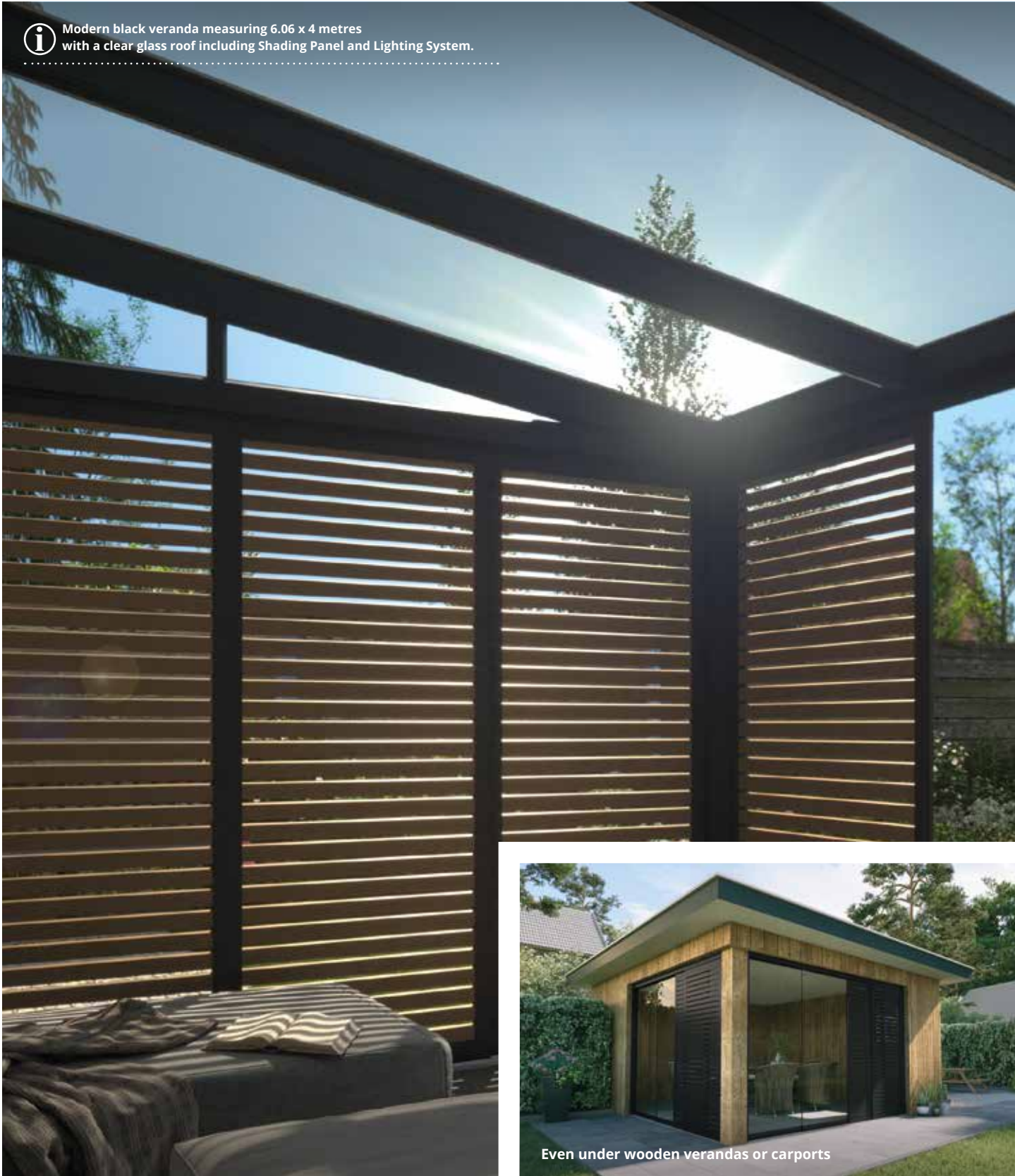

**Configure to your own taste**  
Configure Gumax® Shading Panels to your own taste using the frame and slats in different colours.

**Colour options for the frame:**



**Colour options for the slats:**



Basic colours

Special colours

**Fits under almost any veranda**  
The Gumax® Shading Panel is made of machinable aluminium, which you can easily shorten to the desired height. As a result, the panels fit under almost any veranda, including a wooden veranda or carport. Decide how many Gumax® Shading Panels you want and configure the panel using the different coloured frames (3 colours) and slats (7 colours).

**Rhombus design: stylish & water draining**  
The unique Rhombus design of the slats of Gumax® Shading Panels ensures good drainage. Thanks to the slanted edges of the slats, rainwater that hits them runs off more easily. A water-resistant design with a stylish look.



**More or less ventilation?**  
Would you like additional ventilation under the veranda? Or do you want the veranda to be completely closed off from the air? You have the choice with Gumax® Shading Panels, possibly combined with Gumax® glass sliding doors. Use the panels individually if you want more ventilation or slide them behind a glass sliding door to seal it from air. Determine the space between the slats of the Gumax® Shading Panels yourself with the spacers in 3 sizes.

Optional	
	Price per set
Spacer 10 mm (78 pieces)	£ 37,-
Spacer 13 mm (74 pieces, supplied as standard)	£ 37,-
Spacer 16 mm (70 pieces)	£ 37,-

**Easy assembly**  
You assemble and install Gumax® Shading Panels yourself very easily thanks to the convenient click system, the step-by-step assembly instructions and the clear assembly video.

Gumax® Shading panel		
+ Height can be adjusted as required; + Choice of slats in 7 colours; + Possibility of 3 different slat spacings.		
Height	Basic colours	Special colours
1900 - 2000 mm	£ 469,-	£ 519,-
2050 - 2200 mm	£ 509,-	£ 569,-
2250 - 2300 mm	£ 549,-	£ 609,-
2400 - 2500 mm	£ 589,-	£ 649,-
2600 mm	£ 629,-	£ 669,-



**i** Classic anthracite veranda measuring 6.06 x 3.5 metres with a clear glass roof including sun shading.

"Now I don't suffer from the sun all year, the temperature difference with sun shading is 7 degrees!"

— Patricia —

Sun shading from  
**1.597,-**  
Lowest price guarantee

**Gumax®**  
automatic sun shading

## The new standard in heat and light reflection

Whether it's spring, summer, autumn or winter; you should be able to enjoy your veranda to the fullest during every season.

Gumax® automatic sun shading creates shade where you want it, ensuring a more pleasant temperature.

**i** Classic anthracite veranda measuring 6.06 x 3.5 metres with a clear glass roof including sun shading.

**PATENTED TECHNOLOGY**  
★★★★★

**SUPERIOR COATING**

**LOWEST PRICE GUARANTEE**

Also effective under opal glass and poly roof types

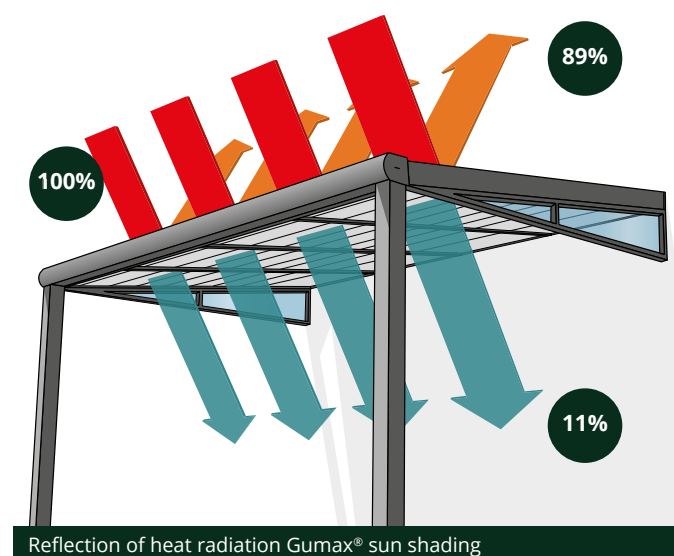

### Effect under polycarbonate and glass verandas

Unlike traditional canvas sun shading screens, Gumax® automatic sun shading not only creates shade, but also effectively reflects heat radiation. This is thanks to the revolutionary sun shading screen made of plastic with woven aluminium threads.

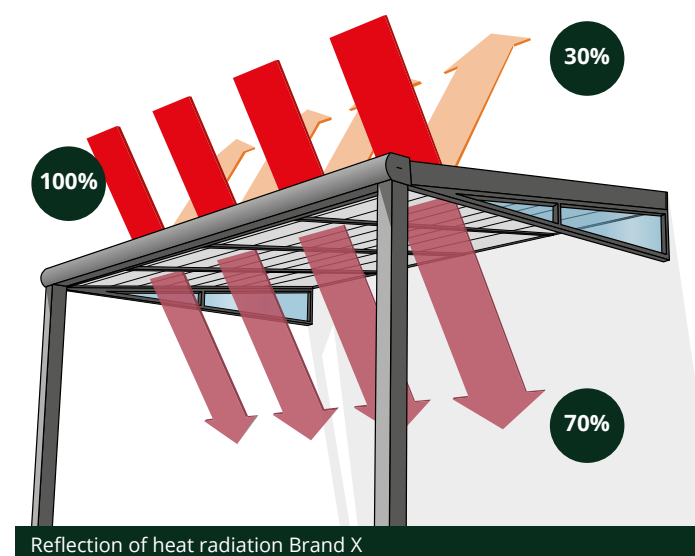

As a result, Gumax® sun shading reflect 73% of visible light and as much as 89% of heat radiation. Gumax® sun shading is effective under verandas with both polycarbonate and glass roof types.





**Underdeck sun shading**  
Gumax® automatic sun shading is mounted under the veranda and between the roof beams. This ensures that the sun shading screen is not subject to external weather influences and dirt. Combined with the compact storage of the screen, this makes Gumax® sun shading very easy to maintain. Because the unique sun shading screen reflects heat radiation at the top, heat does not stay under the veranda. As a result, the temperature under your veranda is significantly lower than with standard sun shading with a canvas screen.

**Sun or shade, it's up to you**  
Gumax® sun shading is easily operated with the included remote control. The electric motors of the sun shading strips can be controlled both collectively and individually. This is possible up to as many as 16 individual lanes. You can also stop the sun shading at any position. This allows you to control where you create shade under your veranda.

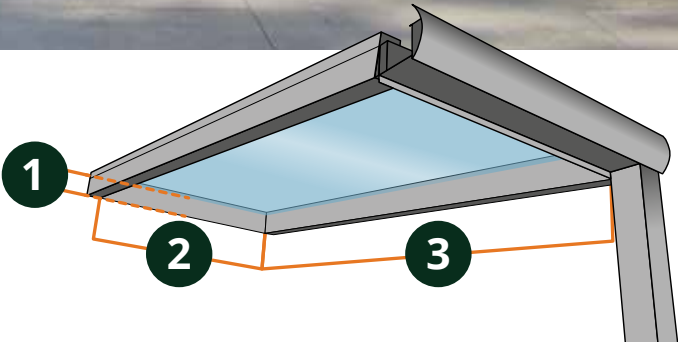

To install Gumax® sun shading under other types of verandas, the space under the veranda must fall within the margins below.	
1 Height (under roof panels):	minimum 88 mm
2 Width (between beams):	936 - 950 mm
3 Length (between wall bracket and gutter):	
Available in length 2,5 m	2463 - 2502 mm
Available in length 3 m	2963 - 3002 mm
Available in length 3,5 m	3463 - 3502 mm
Available in length 4 m	3963 - 4002 mm

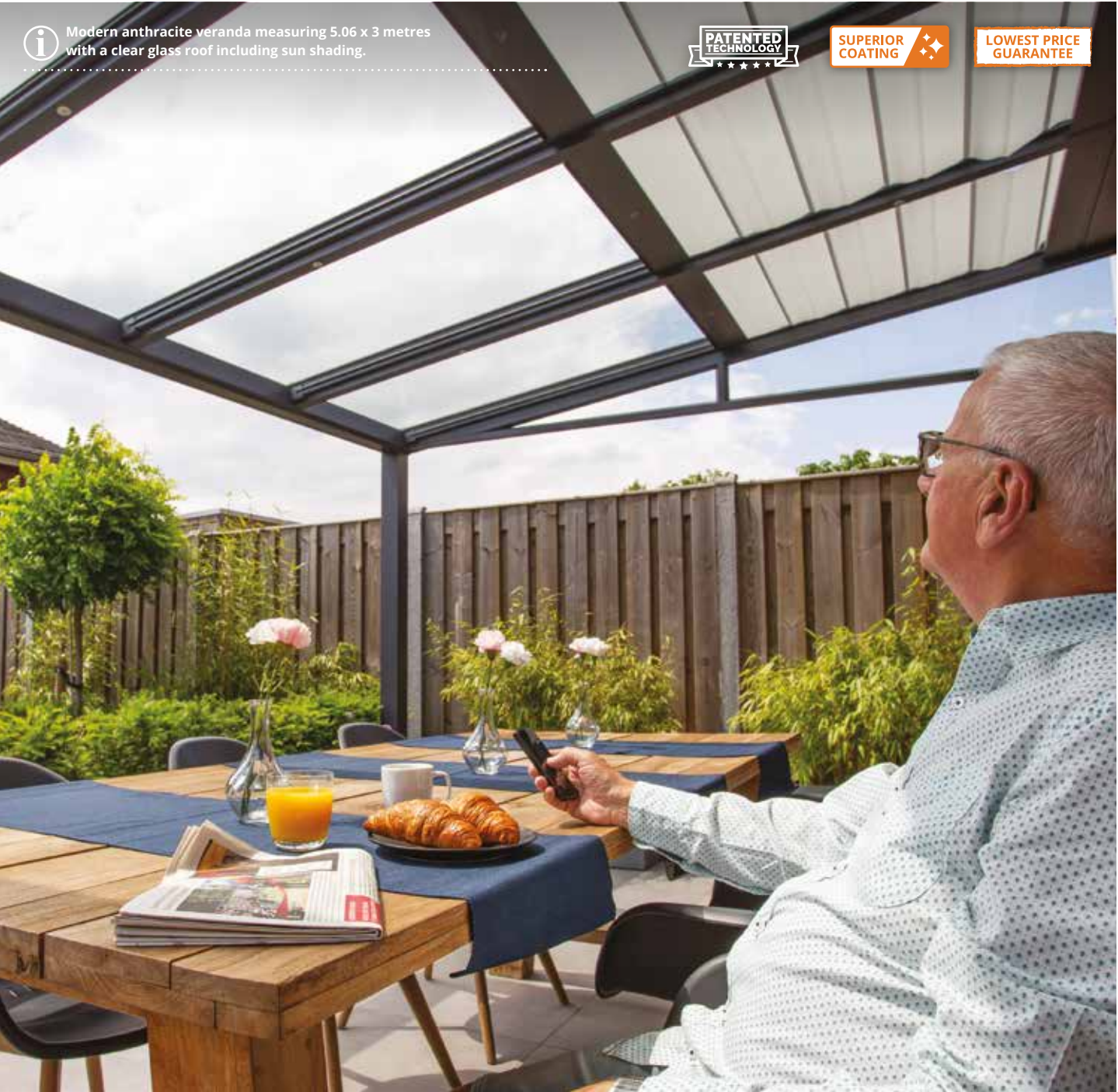

- All benefits listed:**
- + Reflects heat radiation, something other sun shading does not do;
  - + No darkening effect;
  - + Can be operated per individual strip and stopped at any desired position;
  - + 5-year warranty (2 years on moving and electrical parts);
  - + Effective under all roof types, both polycarbonate and glass roof types;
  - + Low maintenance;
  - + Easy-to-assemble construction kit with a step-by-step guide and assembly video.

Gumax® automatic sun shading				
Prices below apply to all colours.				
	2.5 m	3 m	3.5 m	4 m
3.06 m	£ 1.597,-	£ 1.815,-	£ 2.024,-	£ 2.234,-
4.06 m	£ 2.092,-	£ 2.374,-	£ 2.653,-	£ 2.933,-
5.06 m	£ 2.582,-	£ 2.930,-	£ 3.281,-	£ 3.632,-
6.06 m	£ 3.070,-	£ 3.489,-	£ 3.911,-	£ 4.330,-
7.06 m	£ 3.558,-	£ 4.048,-	£ 4.539,-	£ 5.029,-
8.06 m	£ 4.046,-	£ 4.606,-	£ 5.166,-	£ 5.725,-
9.06 m	£ 4.537,-	£ 5.165,-	£ 5.795,-	£ 6.424,-
10.06 m	£ 5.024,-	£ 5.723,-	£ 6.423,-	£ 7.123,-
11.06 m	£ 5.512,-	£ 6.283,-	£ 7.051,-	£ 7.820,-
12.06 m	£ 5.997,-	£ 6.841,-	£ 7.681,-	£ 8.522,-



 Modern anthracite veranda measuring 8.06 x 4 metres with a clear glass roof including glass sliding doors and Lighting System.

**PATENT  
PENDING**

**SUPERIOR  
COATING**

**LOWEST PRICE  
GUARANTEE**

"Atmospheric lighting for your veranda"

Lighting System from

**558,-**

Lowest price guarantee

## Gumax® Lighting System

### Always easily create the right atmosphere under the veranda

Easily choose the right atmosphere under your veranda with Gumax® Lighting System. Choose the right colour for every mood with just the push of a button. Smoothly adjustable from warm white to bright white light and any other colour. Individually adjust each luminaire according to your personal preference. LED lighting for every occasion and any moment. Also controllable via a Smart Home system.

- + Warm white to bright white light;
- + Smooth dimming from bright to soft;
- + Always the right colour;
- + Adjustable per luminaire.



#### Own light scenes

Set up to eight scenes to your liking on the remote control or as many as you want via a Smart Home system.



#### Easy operation

Control the Gumax® Lighting system easily with included remote control or a Smart Home system.



#### Easy Installation

Easy to install by one person. Either under a new or under an existing veranda.



**Modern anthracite veranda measuring 6.06 x 3 metres with an opal glass roof including Lighting System.**



### Set your daily routine

With a Smart Home system, you easily set up Lighting System for your daily automatic routine. This way, your lighting adapts to the time of day.

Bright

12.00

## Spring

19.00

**Relaxed**

Warm and pleasant colours.

22.00

## Metropolitan

Colourful  
and trendy  
accents.

The Gumax® Lighting System fits seamlessly under the intermediate beams of your veranda.

<b>1 Height</b> (under intermediate beam):	22,5 mm
<b>2 Width</b> (equal to intermediate beams):	60 mm
<b>3 Length</b> (between wall bracket and gutter):	
Available in length 2,5 m	2257 mm
Available in length 3 m	2757 mm
Available in length 3,5 m	3257 mm
Available in length 4 m	3757 mm

Modern anthracite veranda measuring 7.06 x 4 metres with a clear glass roof including glass sliding doors and Lighting System.

**LOWEST PRICE  
GUARANTEE**



### Easy operation

**Easy operation**  
Control the Gumax® Lighting System easily with included remote control. Select your desired atmosphere with one of the preference buttons. Choose from soft warm to bright cold or one of eight lighting scenes that you have pre-programmed. It is even possible to manually adjust the individual luminaires of Gumax® Lighting System.

And, of course, as a whole.

- + Personal preference buttons;
- + Adjust each luminaire individually;
- + Programmable.

**Also control with a Smart Home system<sup>2</sup>**

Easily control the Gumax® Lighting system with a Smart Home system. Select your favourite scenes or set your own colour scheme.

Create your personal automatic routine, for example, when a Smart Home system notices you coming home. Always the perfect atmosphere for every occasion under your veranda.

<sup>2</sup> + For use within your smart home system, you must own a bridge that works with Zigbee® technology.

Gumax does not control and is not responsible nor liable for third-party devices and services and their compatibility with Gumax® Lighting System. You can always use the included remote control. Always refer to the full safety instructions, as available (online) in the assembly instructions.









**LOWEST PRICE  
GUARANTEE**



**MARKET LEADER  
IN EUROPE**



**SUPERIOR  
COATING**



**FAST  
DELIVERY**



**365 DAYS PER YEAR  
OPEN & AVAILABLE**

#### Tuinmaximaal

More and more people are enjoying their gardens to the fullest all year round, and that is our goal! We want everyone to have a unique experience in their garden. Whether in summer or winter: you can enjoy every day under your veranda. With our wide range of Gumax® Excellence verandas, glass sliding doors, automatic sun shading, lighting and various accessories at an attractive price, this dream is coming true for more and more people.

#### Lowest price guarantee

Tuinmaximaal guarantees you the lowest prices in the Netherlands, Belgium, Germany, France and the United Kingdom for complete sets of verandas, glass sliding doors, sun shading and lighting. This is because we are on top of the production process, bypassing all middlemen. Normally, each link in the chain has a profit margin added on top of the price, but this is not necessary at Tuinmaximaal!

#### Market leader in Europe

We are the market leader in Europe as we sell 20,000 verandas and glass sliding doors per year. That's because we guarantee the lowest price on all verandas combined with unmatched quality!

#### Gumax® Excellence - Superior coating

- + Superior gloss and colour retention;
- + From AkzoNobel - Interpon, global leader in powder coatings
- + Low maintenance;
- + Designed to meet QUALICOAT performance requirements.

#### Fast delivery

We deliver in all of the Netherlands (with the exception of the Wadden Islands), Belgium, Luxembourg and parts of France, Germany and the United Kingdom.

#### Showroom open 365 days a year

Every day of the year, we are ready to serve you in our showroom! This means you can visit on whatever day is most convenient for you. Be it Christmas or New Year's: we are happy to help you!

#### Warranty

You have a five-year manufacturer's warranty on all Gumax® products<sup>4</sup>.

<sup>4</sup> + 2 years of warranty on moving and electrical parts of the Gumax® sun shading.

You can configure your veranda (or carport), with sliding doors, sun shading and lighting yourself in the web shop: simple, quick and complete!

# tuinmaximaal.co.uk

#### Can we help you?

Do you have questions about our products or would you like to go through the ordering process with one of our staff members? We are happy to help you! Every day, over 200 employees ensure that you are served in the best possible way.

Contact our staff by phone and we will walk you through the ordering process step by step or can prepare a quote for you.

#### Showroom + Warehouse:

Rooijakkersstraat 8 + 5652 BB Eindhoven + The Netherlands

#### Contact

+44 (0)330 818 3230 + info@tuinmaximaal.co.uk



**Follow the virtual tour of our showroom  
via the contact page**

**Follow us online as well:**



Did you know that Tuinmaximaal is committed to achieving high customer satisfaction?

Prices (£) stated include VAT and shall be valid until **30-06-2024**, subject to changes and printing errors. No part of this publication may be reproduced in any form without permission by Tuinmaximaal.